



Carron

SIMPLY SOME OF
THE FINEST
FIREPLACES AVAILABLE

freephone: 0808 129 2224
www.carron.uk.net
email: sales@carron.uk.net

Carron



SIMPLY SOME OF THE FINEST
FIREPLACES AVAILABLE
www.carron.uk.net

contents	
combinations	3-25
inserts	26-46
hobs	47
baskets	48-49
surrounds	50-77
tiles	78-79
hearths	78



specifications
Please note all measurements are approximate and may vary slightly. Please allow a tolerance of plus/minus 10mm. We endeavour to ensure that all colours are as accurate as possible, however we recommend you check with your retailer before placing an order.

solid fuels
If using solid fuels please be aware that they will discolour polished or brass products. If this is a concern we recommend selecting a full black finish. Do not use **anthracite** or **petroleum coke** as this will significantly reduce the life of the product.

fitting
The fitting of our products must be carried out or supervised by a **Hetas qualified solid fuel engineer**. We accept no responsibility for any products that are not installed in this way. A list of qualified engineers is available from www.hetas.co.uk

care of your fireplace
To keep your fireplace in prime condition, please follow these simple care instructions:-

for full polish finish:-
Keep oiled using a thin coat of a light oil such as 3 in 1 oil. This treatment should be carried out twice a year or as required. Any surface rust should be removed using a fine wire wool and then re-oiled. Avoid exposing the cast iron surface to moisture.

for highlight/black finish:-
Coat with an iron paste and buff up to enhance the finish of your fireplace. Do not use spray polish or any other method of cleaning than above.

Cast iron is a natural material, which is subject to minor imperfections and should be considered part of its characteristic.

We reserve the right to amend designs without prior notification. Please consult your retailer prior to placing an order.

gas fires
All our gas fires are manufactured in the UK and comply to all CE requirements and British standard BSEN509:2000. They come complete with flame failure device and oxygen depletion system. All gas fires must be fitted by a Gas Safe registered installer.

the victorian small combination



code: HEF043 finish: full polish
ashpan: DJX039
no gas fire available with this combination

The Victorian style cast iron fireplace is perfect in size, design and stature for placement in a bedroom or in smaller rooms of a household.

It is designed with intricate fruit and urn artwork and completed with a beautifully sunken archway.



also available:
code: HEF246 finish: black

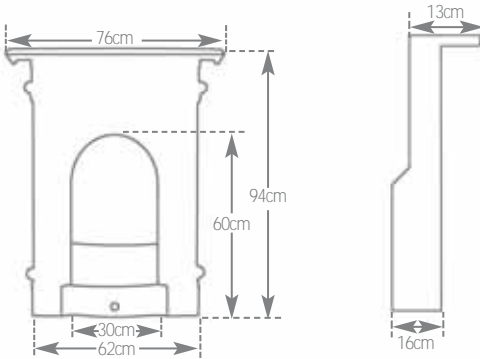

the jasmine combination



also available:
code: HEF044 finish: full polish

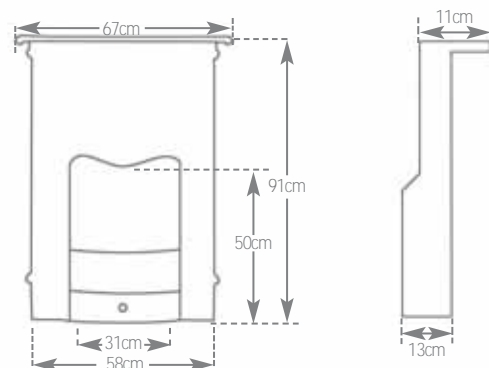

code: HEF247 finish: black
ashpan: DJX039
gas fire available to suit: MLG040 flue type: class 1 or 2
gas fire heat input: 6kw

The Jasmine is an Art Nouveau Style cast iron fireplace, framed beautifully with an orchid stem design and an elegantly detailed canopy.

the toulouse combination



also available:
code: RX254 finish: black
tiles shown: LGC080
(2 boxes required)

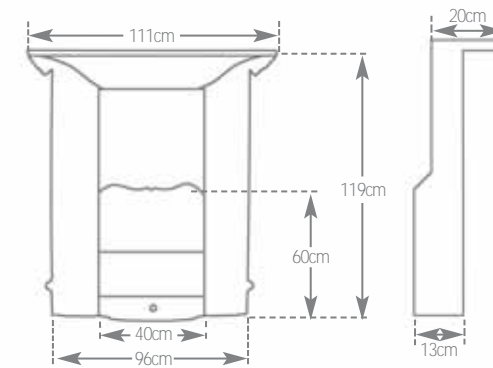

code: RX141 finish: full polish
tiles shown: LGC065 (2 boxes required) ashpan: HEF037
gas fire available to suit: MLG067 flue type: class 1 or 2
gas fire heat input: 6.3kw

The Toulouse cast iron fireplace boasts a magnificent design in the art nouveau style, decorated with four tulips and accompanying leaves.

The fireplace's unique vine artwork framing is complimented by the colour of the partly visible tiles that complete the background.

the verona combination

the morris combination

also available:
code: RX246 finish: black
tiles shown: LGC087

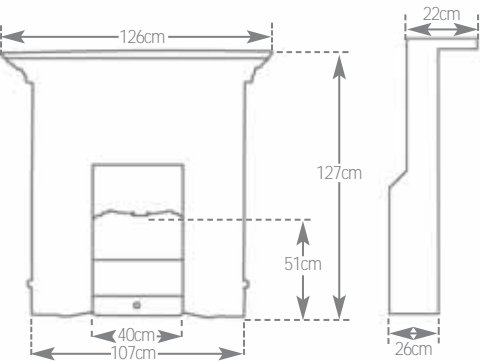

code: RX138 finish: full polish ashpan: HEF037
tiles shown: LGC012 gas fire available to suit: MLG071
flue type: class 1 or 2 gas fire heat input: 6.3kw

The Verona is an Art Nouveau cast iron tiled fireplace with straight-stemmed floral design within the cast framing.

also available:
code: RX131 finish: full polish
tiles shown: LGC083

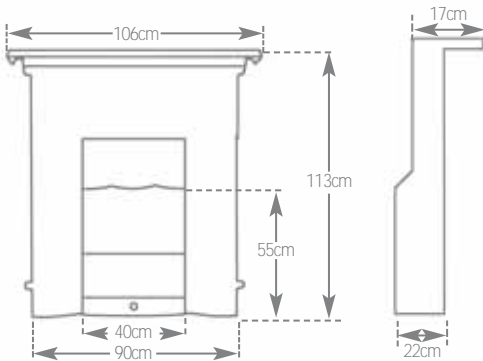

code: RX132 finish: black tiles shown: LGC083
ashpan: HEF037 solid fuel brick: RX212
gas fire available to suit: MLG069 flue type: class 1 or 2
gas fire heat input: 6.9kw

The Morris cast iron fireplace's floral detail acts as the centre point to an elegant Art Nouveau design, which is complimented by intricate floral detailing on a shaped canopy and tile holders within the framing.

the valentine combination

the tweed combination



also available:
code: RX134 finish: black
tiles shown: LGC087



code: RX133 finish: full polish ashpan: HEF037
tiles shown: LGC087 solid fuel brick: RX212
gas fire available to suit: MLG069 flue type: class 1 or 2
gas fire heat input: 6.9kw

The Valentine is an Art Nouveau cast iron fireplace, styled with a symmetrical pomegranate design that extends from the centre of the frieze to fill the legs of the framework.

The design can be brought to life with the tube lined tiles that sit either side of the fireplace's artistic canopy.

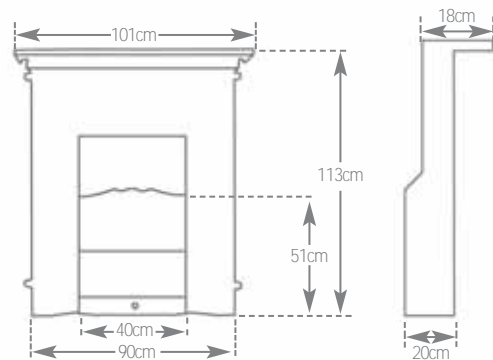

code: RX063 finish: full polish ashpan: HEF036 solid fuel brick: RX217
gas fire available to suit: MLG005 flue type: class 1 or 2
gas fire heat input: 6.95kw

The Tweed is a Victorian style cast iron fireplace. Its numerous outstanding features include the chain link detail that highlights the fireplace's arch, framed majestically with a sunflower detail.

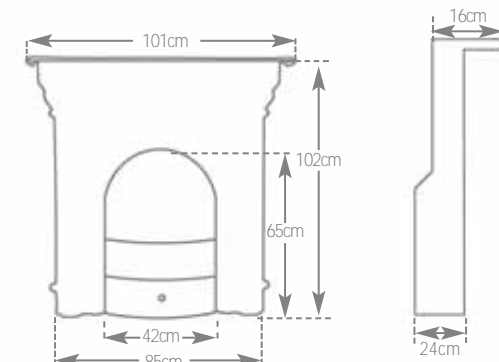

the victorian large combination

the melrose combination



also available:
code: RX136 finish: black

also available:
code: RX094 finish: full polish

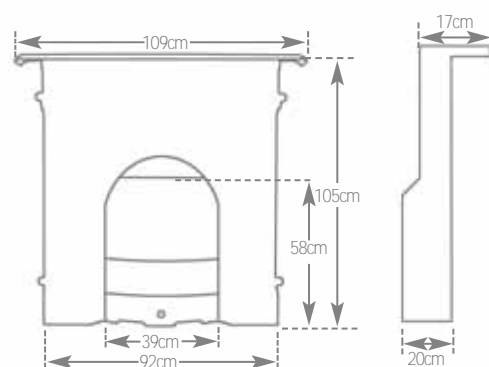

code: RX135 finish: full polish
ashpan: HEF037
gas fire available to suit: MLG063 flue type: class 1 or 2
gas fire heat input: 6.3kw

The Victorian style cast iron fireplace is designed with intricate fruit and urn artwork and completed with a beautifully sunken archway, complete with a small but striking canopy.

code: RX249 finish: black
ashpan: HEF036
gas fire available to suit: MLG035 flue type: class 1 or 2
gas fire heat input: 6.9kw

The Melrose cast iron fireplace is designed in the Victorian style, with a narrow arch that is complimented beautifully by the intricate floral artwork at each corner.

A repeated leaf pattern causes the framing to stand out, and is matched elegantly underneath the fireplace's imposing shelf.

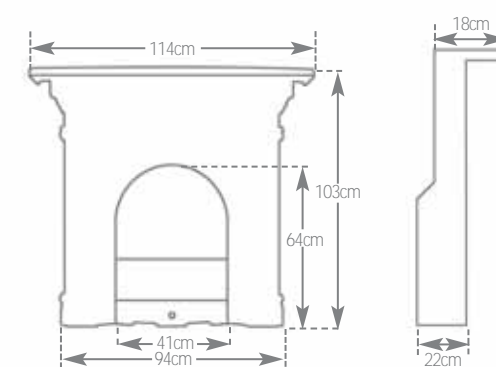

the jekyll combination

the oxford combination

also available:
code: HEF056 finish: full polish

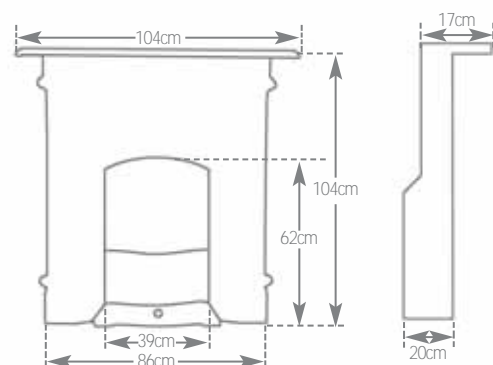

code: SEF011/HEF403 finish: black
ashpan: HEF037
gas fire available to suit: MLG023 flue type: class 1 or 2
gas fire heat input: 6.3kw

The surround to the Jekyll cast iron fireplace acts as a striking frame to a stunning Victorian design. The decorative artwork beneath the shelf features birds and butterflies amidst detailed foliage, while the half-archway is bordered by a classy weave and pendant combination.



code: HEF352 finish: black
no gas fire available with this combination

The Oxford is a cast iron fireplace in the Victorian design. Its simplistic design features a straight-lined framing, offering a classic appearance that would be suitable to any home.

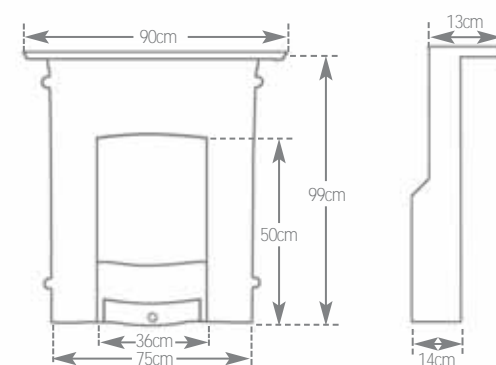

the bella combination

the gothic combination

also available:
code: RX090 finish: black

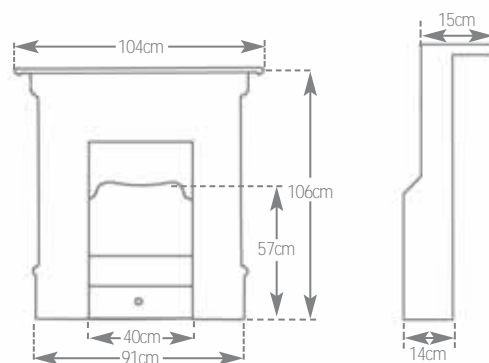

code: RX060 finish: full polish
ashpan: HEF037 solid fuel brick: RX214
gas fire available to suit: MLG010 flue type: class 1 or 2
gas fire heat input: 6.3kw

The Bella is a cast iron fireplace in the Art Nouveau style, with stylistic patterning that runs along the frieze and framing. The artistic canopy offers a masterfully textured design with floral patterning.



code: HEF055 finish: highlight polish
gas fire available to suit: MLG057 flue type: class 1 or 2
gas fire heat input: 6.95kw

The Gothic Revival style cast iron fireplace is elegantly simplistic, with a commanding archway that is decorated with an impressive repeated design.

The highlighted columns are striking in their presence, based on bold feet, and joined with a gothic patterning beneath the shelf.

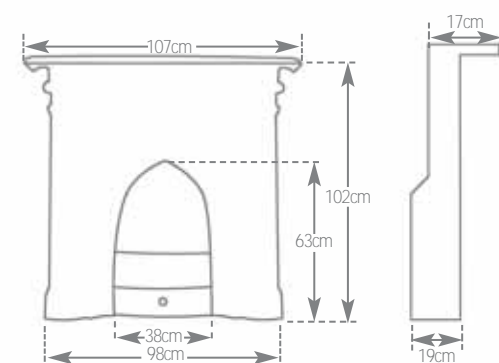

the knaresborough combination

the lambourn

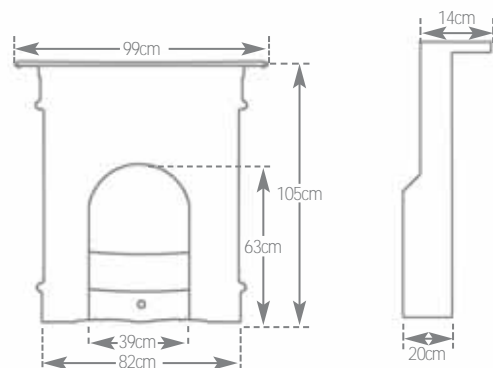

code: RX140 finish: black
ashpan: HEF037
gas fire available to suit: MLG066 flue type: class 1 or 2
gas fire heat input: 6.3kw

The Knaresborough cast iron fireplace is a combination of a Victorian design with gothic features. The elaborate sunflower artwork surrounds a rounded arch and is accompanied by an adjoining canopy.

The attractive design is complimented by features in each corner, sitting below the fireplace's broad shelf.

code: RX160 finish: black ashpan: HEF036
tiles shown: LGC067 gas fire available to suit: MLG072
flue type: class 1 or 2 gas fire heat input: 6.95kw

The Lambourn cast iron fireplace is a Victorian design with a variety of attracting features. The framed rectangular panels that sit beneath the large shelf is accompanied by a hooded canopy with wonderful detail.

While the uniquely shaped legs stand beside inner tile holders to add to the striking nature of the fireplace.

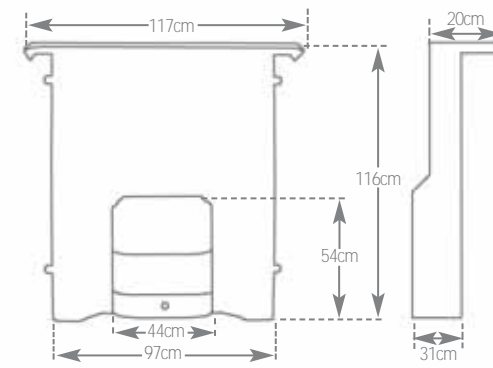

the hamden

the bella small combination

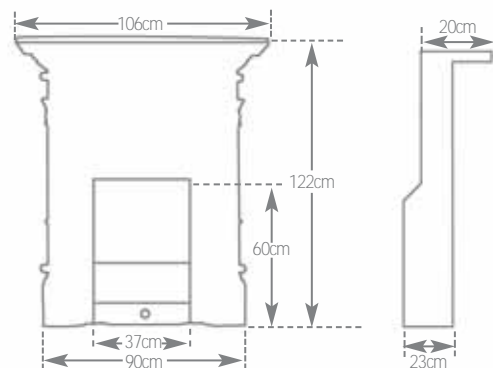

code: RX163 finish: black
ashpan: HEF037
gas fire available to suit: MLG073 flue type: class 1 or 2
gas fire heat input: 6.9kw

The Hamden is a Victorian cast iron fireplace with spectacular detailing throughout. The detailed floral design beneath the fireplace's shelf is matched in the canopy, adding elegance to the striking beading and mosaic detailing that fills both the exterior and interior frame.

code: HEF359 finish: full polish
ashpan: DJX039
no gas fire available with this combination

The Bella is a cast iron fireplace in the Art Nouveau style, with stylistic patterning that runs along the frieze and framing. The artistic canopy offers a masterfully textured design with floral patterning.

At 93cm x 74cm, it is more suited to the smaller rooms of a household than, in comparison, the Bella Large Combination. (106cm x 104cm)

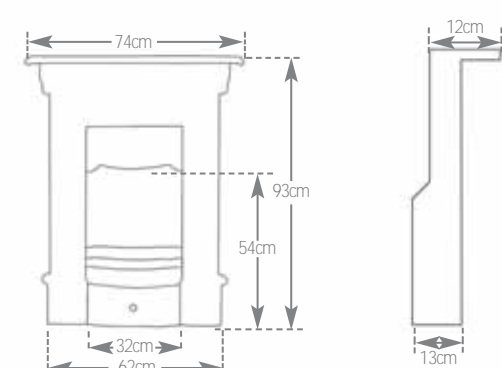

the tulip combination

the winchester combination



also available:
code: RX059 finish: full polish

also available:
code: HEF204 finish: black

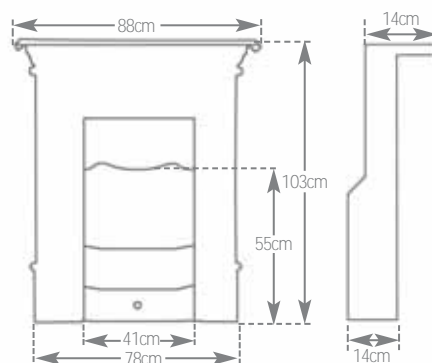

code: RX089 finish: black
ashpan: HEF037 solid fuel brick: RX214
gas fire available to suit: MLG018
flue type: class 1 or 2 gas fire heat input: 6.3kw

The Tulip is an understated Art Nouveau cast iron fireplace, with a classically simplistic design that presents a smooth frame and a shaped plain canopy. A classy tulip design sits attractively between the canopy and the shelf.

code: HEF243 finish: highlight polish
ashpan: DJX039
gas fire available to suit: MLG042 flue type: class 1 or 2
gas fire heat input: 6.3kw

The Winchester is an Art Nouveau cast iron fireplace with perfectly minimalistic features. A square opening is framed neatly and encircled with a sunken tulip design.

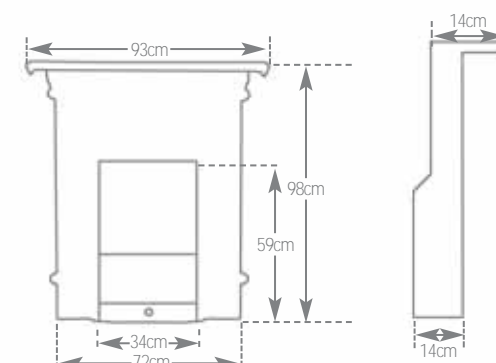

the hawthorne combination

the crocus combination



code: RX139 finish: black
ashpan: DJX039
gas fire available to suit: MLG065 flue type: class 1 or 2
gas fire heat input: 6.3kw

The Hawthorne is a Georgian cast iron fireplace that displays a wonderful attention to detail. The repeated artistic finish within the framing of a half-arched opening is divided perfectly by a circular flower design, a feature which is matched by the half-flowers that reappear beneath the fireplace's curved overhanging shelf.

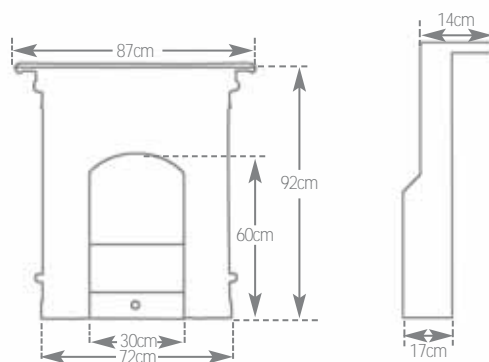

code: RX066 finish: full polish
ashpan: DJX039
gas fire available to suit: MLG017 flue type: class 1 or 2
gas fire heat input: 6.3kw

The Crocus is a cast iron fireplace in the Art Nouveau style. The impressive design consists of a stemmed flower detail along the length of the frame, wearing either side of a tall, narrow opening and a meticulously detailed canopy with a textured finish.

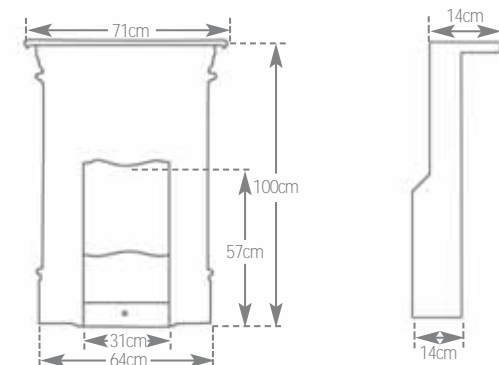

the abbot combination

the abingdon combination



also available:
code: HEF193 finish: full polish

also available:
code: HEF354 finish: black

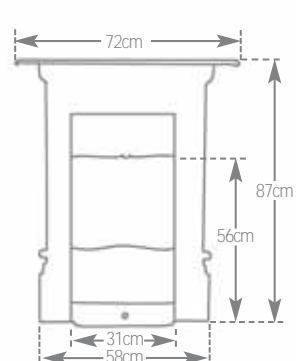

code: HEF192 finish: highlight polish
ashpan: DJX039
no gas fire available with this combination

The Abbot is an Art Nouveau cast iron fireplace that combines an elegantly simplistic design with an impressively imposing presence. The fireplace's smooth frame combines with a classy triple tulip detail beneath the shelf and a decorated curved canopy.

code: SEF018/HEF355 finish: full polish
ashpan: HEF037
gas fire available to suit: MLG035 flue type: class 1 or 2
gas fire heat input: 6.9kw

The Abingdon cast iron fireplace is a Victorian design with a stylishly simplistic finish. The Abingdon provides a traditional shape with a bold appearance and a flat mantel.

The curved base of the canopy provides an added quirk to the classic shape of the fireplace's frame.

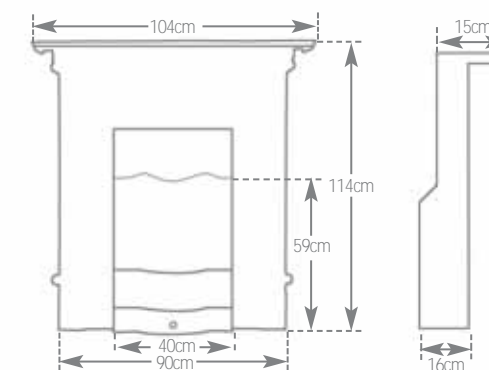

the royal insert (narrow opening)



also available:
code: RX128 finish: black
surround: RX257



code: RX127 finish: full polish surround: RX144
ashpan: HEF037
gas fire available to suit: MLG070 flue type: class 1 or 2
gas fire heat input: 6.3kw

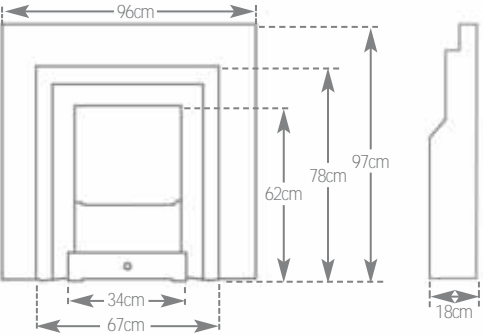

The Royal is a cast iron fireplace insert in the Georgian style. It is an imposing, straight-edged insert that, with its bold shape and square opening, is sure to immediately command attention.

At 96cm x 97cm, the Royal Narrow is a slightly smaller version of the Royal (102cm x 102cm).

the royal insert



also available:
code: RX283
finish: highlight polish (above)
code: RX130 finish: black (below)
surround: RX101



code: RX129 finish: full polish surround: RX100
ashpan: HEF036 solid fuel brick: RX221
gas fire available to suit: MLG014 flue type: class 1 or 2
gas fire heat input: 6.95kw

The Royal is a cast iron fireplace insert in the Georgian style. It is an imposing, straight-edged insert that, with its bold shape and square opening, is sure to immediately command attention.

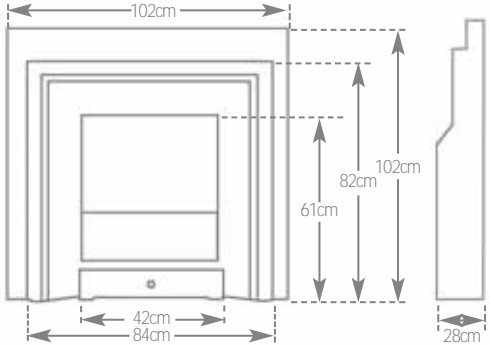

the scotia insert

the london plate insert (wide opening)



code: RX087 finish: black surround: RX121
ashpan: HEF036 solid fuel brick: RX216
gas fire available to suit: MLG006 flue type: class 1 or 2
gas fire heat input: 6.95kw

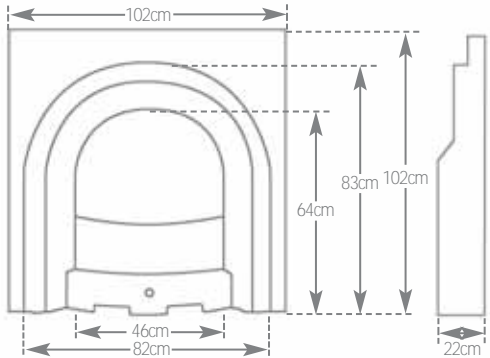

The Scotia is a cast iron fireplace insert in the Early Victorian style. The opening to The Scotia is surrounded by a double archway, both with wonderfully different designs that compliment each other.



code: RX143 finish: black surround: SMC177
ashpan: DJX038
gas fire available to suit: MLG068 flue type: class 1 only
gas fire heat input: 6.9kw

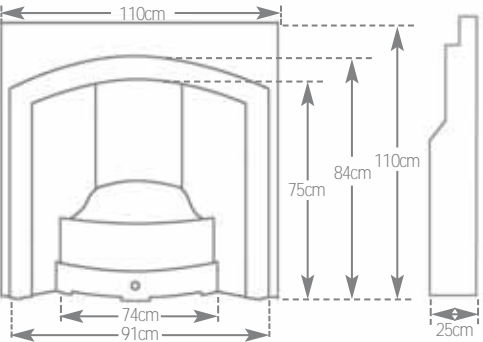

The London Plate is an Early Victorian cast iron fireplace insert, with an elegantly simple and wide half-arched opening. The curve of the basket perfectly matches the design of the arch's frame, giving the insert an undoubtedly appealing appearance.

also available:
code: RX142 finish: full polish
surround: RX112



the celtic arch insert

the ce lux insert



full polish



half polish

also available:
code: RX082 finish: full polish
code: RX293 finish: half polish
code: RX010 finish: highlight polish
surround: TH559



code: RX204 finish: black surround: SSU068
ashpan: HEF036
gas fire available to suit: MLG001 flue type: class 1 or 2
gas fire heat input: 6.95kw

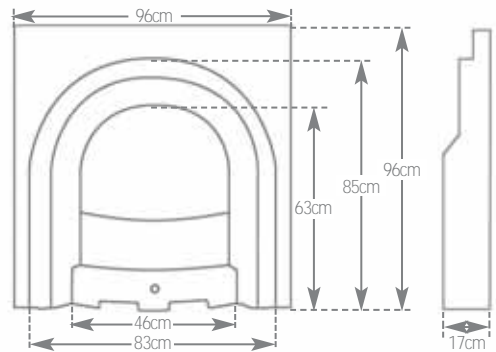

The Celtic Arch is a large cast iron fireplace insert in the Victorian style. It has a classically simple design, with a smooth finish that adds to the presence of the perfectly curved arch opening.

The curved bars at the front of the opening match the style of the archway, giving the insert a complete feel.



also available:
code: HEF321 finish: black
surround: TH557



code: HEF304 finish: highlight polish surround: TH557
ashpan: HEF036
gas fire available to suit: MLG069 flue type: class 1 or 2
gas fire heat input: 6.9kw

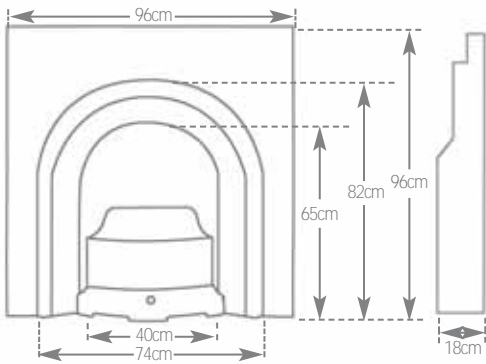

The Ce Lux is a Victorian style cast iron fireplace insert. Beautifully intricate detailing surrounds the outer rim of a large arched opening, with an inner archway that is decorated with sophisticated beading.

the falkirk insert



code: RX003 finish: highlight polish surround: TH558
ashpan: HEF036
gas fire available to suit: MLG001 flue type: class 1 or 2
gas fire heat input: 6.95kw

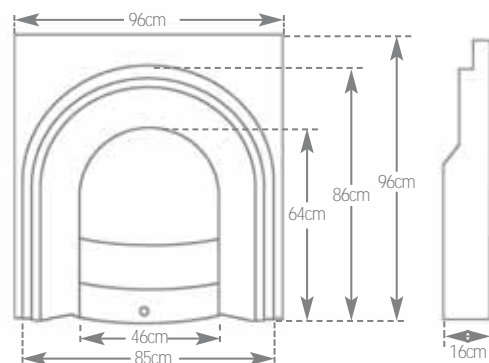

The Falkirk is a Late Victorian cast iron fireplace insert. It has an ornate arch which works in perfect harmony with a smooth rectangular frame.

The double-arch decoration runs the entire length of the opening, and serves to beautifully frame the curved basket, decorated itself with a central leaf design and highlighted patterning on the inner rim.

the tiffany insert



code: RX002 finish: highlight polish surround: TH552
ashpan: HEF036
no gas fire available with this insert

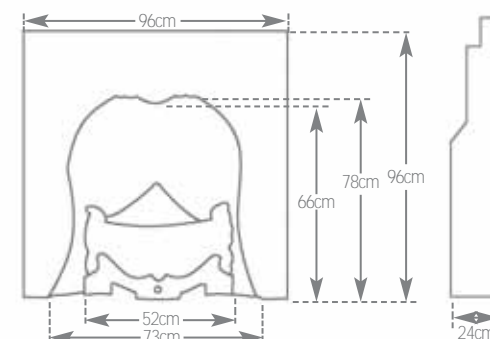

The Tiffany is a cast iron fireplace insert in the Early Victorian style. Its inverted horseshoe archway creates a unique appeal that is increased by the delicate fruit and branch decoration that adorns the edges.

This sparse decoration is complemented by further symmetrical fruit and leaf detailing at the top of the arch. The look is completed with a highly ornate scrolled basket and ash cover.

the prince insert

the westminster insert



code: RX088 finish: black surround: RX256
ashpan: HEF036
gas fire available to suit: MLG006 flue type: class 1 or 2
gas fire heat input: 6.95kw

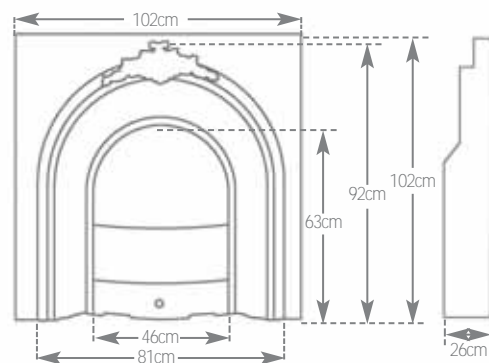

The Prince is an Early Victorian cast iron fireplace insert. The arched opening is decorated at the top with eye catching detail, further emphasised by the classy simplicity of the insert.

The basket and ash cover blend in perfectly, with curved bars and floral artwork.



code: RX114 finish: highlight polish surround: RX101
ashpan: DJX038 solid fuel brick: RX236
gas fire available to suit: MLG045 flue type: class 1 only
gas fire heat input: 9kw

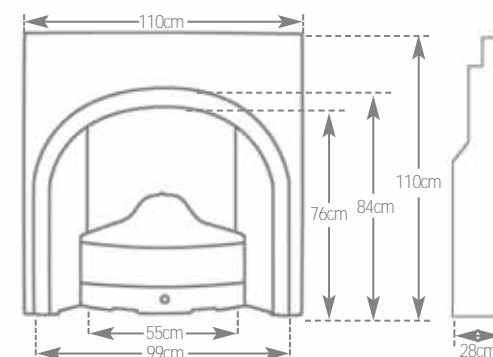

The Westminster is a cast iron fireplace insert in the Georgian style. The outline of its wide archway is decorated with a twisted rope detail. The arch's angled decline is filled at the front with an accompanying basket with curved bars, the base of which is detailed in a way to compliment the arch itself.

the kensington insert

the cherub insert



code: RX110 finish: brass trim highlight surround: RX101
ashpan: DJX038 solid fuel brick: RX237
gas fire available to suit: MLG055 flue type: class 1 only
gas fire heat input: 9kw

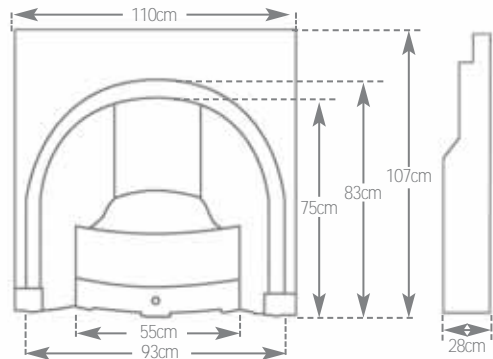

The Kensington cast iron fireplace insert is an attractive design in the Georgian style. The archway is decorated with wonderful detailing, highlighted by the brass trim finish and complimented by the rope twist bars that curve around the insert's opening.



code: RX145 finish: highlight polish surround: RX101
ashpan: DJX038 solid fuel brick: RX237
gas fire available to suit: MLG068 flue type: class 1 only
gas fire heat input: 9kw

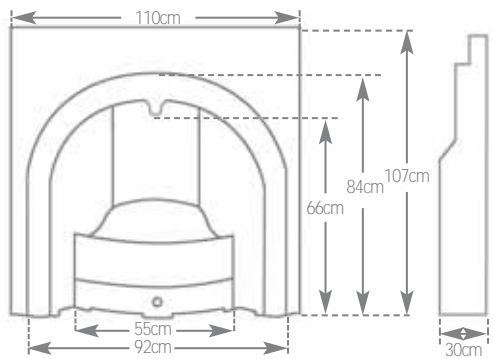

The Cherub is a cast iron fireplace insert in the Georgian style, complete with a plain fascia and a wide arch opening. The arch is decorated with a floral vine detail running symmetrically along the edges, meeting at the top to frame a wonderful image. A cherub design sits atop block feet either side of the arch.

the rococo insert

the london plate insert



code: RX263 finish: black surround: RX101
ashpan: DJX038 solid fuel brick: RX237
gas fire available to suit: MLG068 flue type: class 1 only
gas fire heat input: 9kw

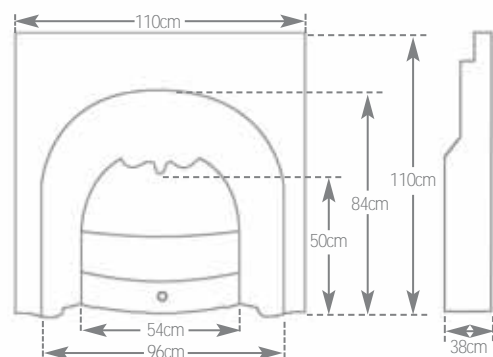

The Rococo is a cast iron fireplace insert with its own unique style. The spectacularly intricate detail that surrounds the rounded arch demonstrates the highest level of design that can be achieved through casting.



code: RX091 finish: full polish surround: SMC103
ashpan: HEF036
gas fire available to suit: MLG005 flue type: class 1 or 2
gas fire heat input: 6.9kw

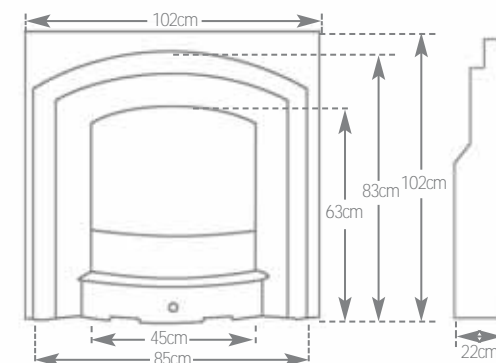

The London Plate is an Early Victorian cast iron fireplace insert, with an elegantly simple and wide half-arched opening. The curve of the basket perfectly matches the design of the arch's frame, giving the insert an undoubtedly appealing appearance.

also available:
code: RX205 finish: highlight polish
code: RX092 finish: black (below)
surround: SMC103



the laurel insert

the coleby arched insert

also available:
code: HEF343 finish: black
surround: SMC107 tiles: LGC094

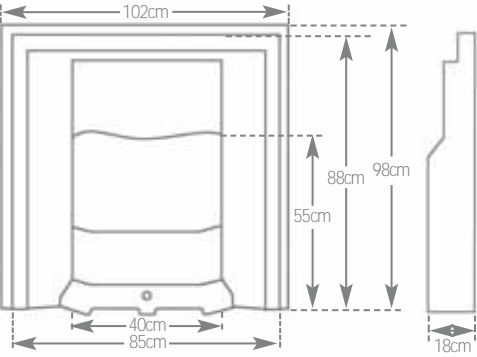

code: HEF341 finish: highlight polish surround: SMC107 tiles: LGC013
ashpan: HEF037
gas fire available to suit: MLG036 flue type: class 1 or 2
gas fire heat input: 6.9kw

The Laurel is a Late Victorian cast iron fireplace insert. Its grand canopy is decorated with a fruit and urn detail and is made to look all the more prominent by the connecting pillars that run down to the strong basket at the foot of the opening.



code: RCM002 finish: highlight polish surround: SMC118
ashpan: HEF036 gas fire available to suit: MLG082
flue type: class 1 or 2 gas fire heat input: 6.9kw

The Coleby is a cast iron fireplace insert that is as noticeable for its shape as its decoration. A smooth archway bulges from the insert's surface to curve around the fireplace's opening, which is itself set back.

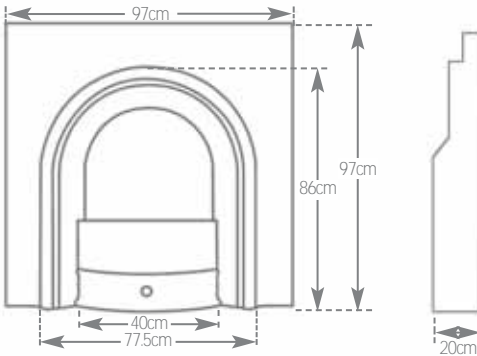

also available:
code: RCM005 finish: black
surround: SMC118



the collingham arched insert

the beckingham arched insert

also available:
code: RCM004 finish: black
surround: SMC171

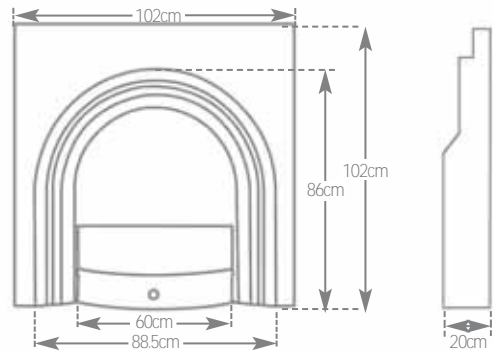

code: RCM001 finish: highlight polish surround: SMC171
ashpan: HEF036
gas fire available to suit: MLG081
flue type: class 1 or 2 gas fire heat input: 6.9kw

The Collingham is a cast iron fireplace arched insert with a unique triple arch design that surrounds a beautifully shaped opening. The inner archway frames are decorated with variations on a toothed patterning, the designs of which are further emphasised by the highlight polish finish.



also available:
code: RCM006 finish: black
surround: TH554

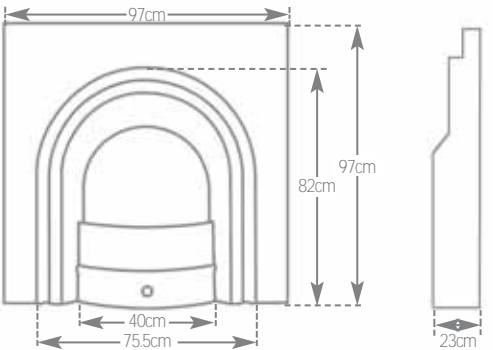

code: RCM003 finish: highlight polish surround: TH554
ashpan: HEF036
gas fire available to suit: MLG080
flue type: class 1 or 2 gas fire heat input: 6.9kw

The Beckingham is a cast iron fireplace insert that is sure to catch the eye. The small fireplace opening affords the insert the room to allow its spacious features to stand out. A large exterior frame combines with a smaller interior curve to frame an eccentrically patterned arch.

the aladdin insert

the daisy insert



code: RX123 finish: highlight polish surround: SMC007 tiles: LGC086
ashpan: HEF037
gas fire available to suit: MLG060
flue type: class 1 or 2 gas fire heat input: 6.9kw

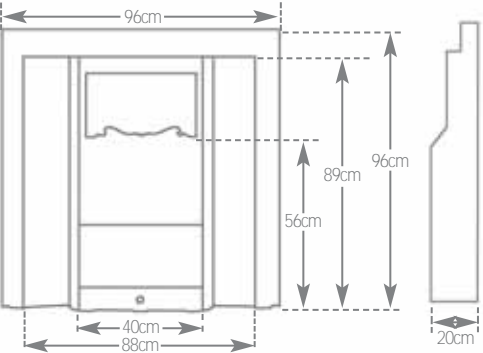

The Aladdin is a cast iron fireplace insert in the Late Victorian style. Its square shape is framed by a repeated celtic decoration, which becomes emphasised by the highlighted polish finish. The decorative celtic theme is continued on the bulbous canopy, intertwined with floral patterning and an urn.



code: RX125 finish: highlight polish surround: SMC011 tiles: LGC085
ashpan: HEF036
gas fire available to suit: MLG062 flue type: class 1 or 2
gas fire heat input: 6.9kw

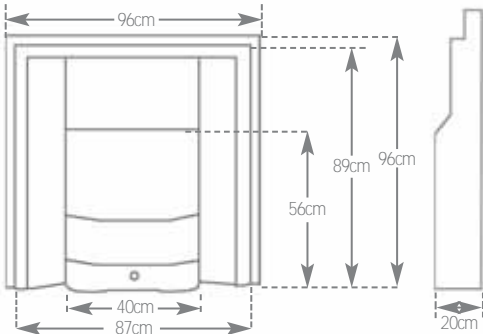

The Daisy cast iron fireplace insert is a Late Victorian design, with a rectangular shape and curved frame that is decorated with highlighted intertwining vines. The corners of the frame are marked by floral patterns, which are matched at the mid-point of each leg.

the camden insert



code: RX001 finish: highlight polish surround: TH556 tiles: LGC072
ashpan: RX282
gas fire available to suit: MLG026 flue type: class 1 or 2 gas fire
heat input: 6.9kw

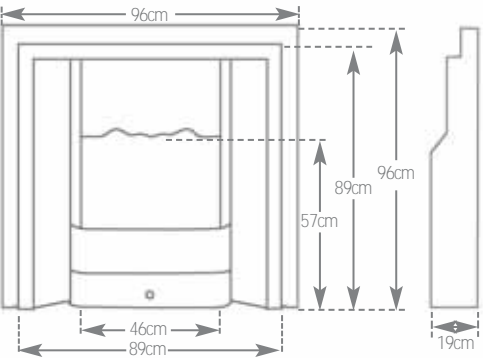

The Camden is a cast iron fireplace insert in the Late Victorian style. The sequential indented design around the outside of the insert's frame is both simple and stylish, combining beautifully with the more extravagant highly ornate canopy that is filled with urn and floral decorations.

the queensferry hob grate



code: HEB203 finish: black surround: SM177
gas fire available to suit: MLG037 flue type: class 1 or 2
gas fire heat input: 6.3kw

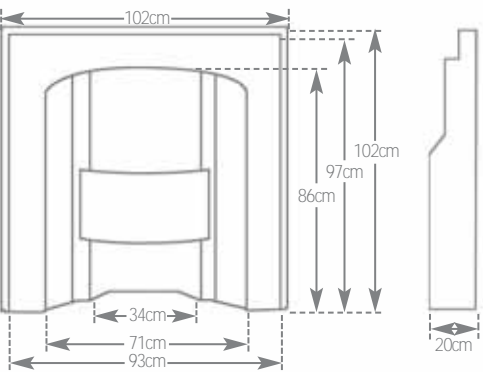

The Queensferry is a traditional cast iron hob grate. Its uniquely raised basket with triple bar cover is supported by decorative panels that are mirrored along the insert's frame. A floral pendant is positioned in each top corner, combining with a matching horizontal plaque to complete the design.

the balmoral basket

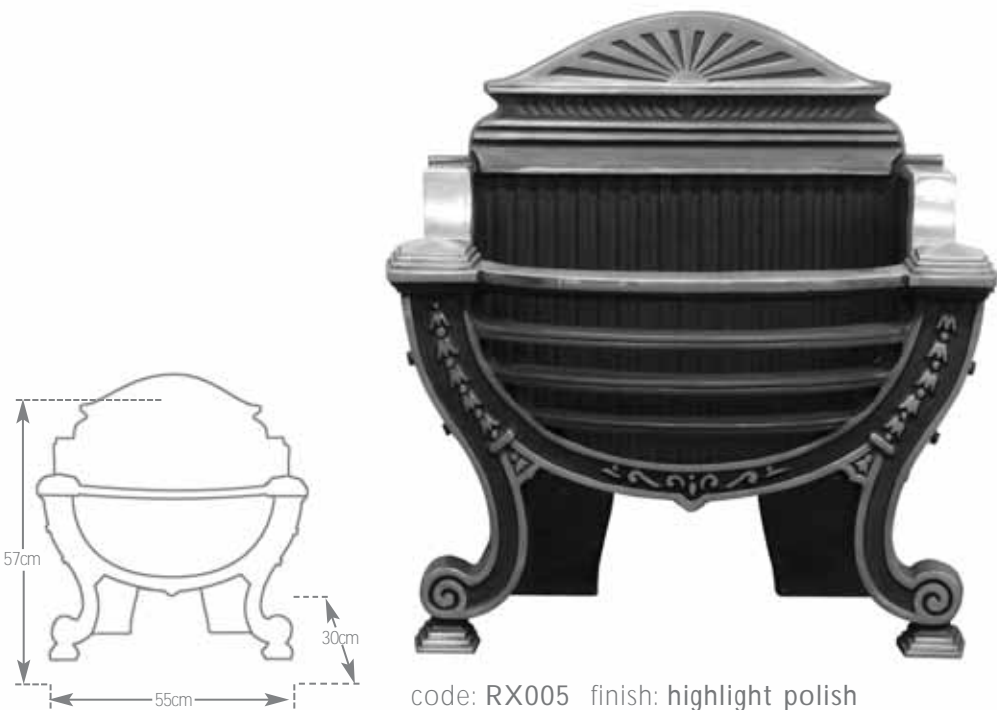

code: RX005 finish: highlight polish
ashpan cover to suit: RX203
gas fire available to suit: MLG012
flue type: class 1 only
gas fire heat input: 9kw



the dorchester basket



code: RX004 finish: highlight polish
ashpan cover to suit: RX202
gas fire available to suit: MLG011
flue type: class 1 only
gas fire heat input: 9.4kw

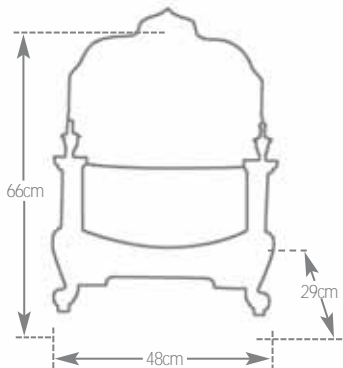

the georgian basket

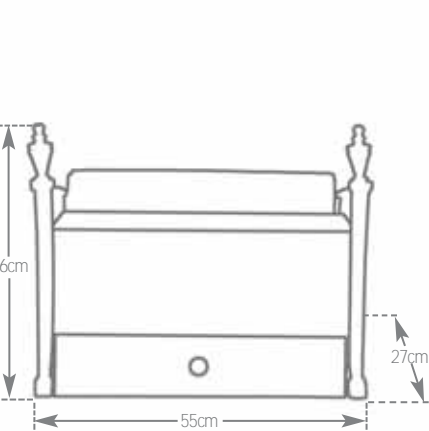

code: RX151 finish: black
gas fire available to suit: MLG004
flue type: class 1 only
gas fire heat input: 9.4kw



code: RX149 finish: full polish
gas fire available to suit: MLG004
flue type: class 1 only
gas fire heat input: 9.4kw



code: RX150 finish: black
gas fire available to suit: MLG002
flue type: class 1 only
gas fire heat input: 9.4kw



code: RX148 finish: full polish
gas fire available to suit: MLG002
flue type: class 1 only
gas fire heat input: 9.4kw

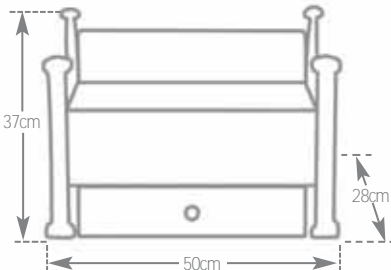

the clyde basket



code: RX295 finish: black



code: RX256 finish: black

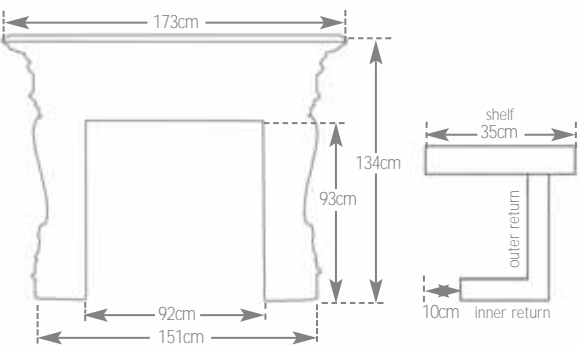

also available:
code: RX067 finish: full polish

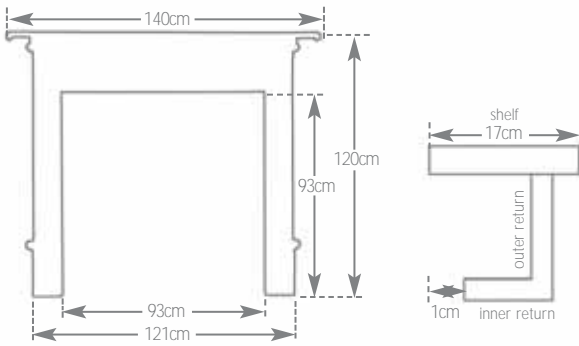

the belgrave surround

the somerset surround



code: RX144 finish: full polish

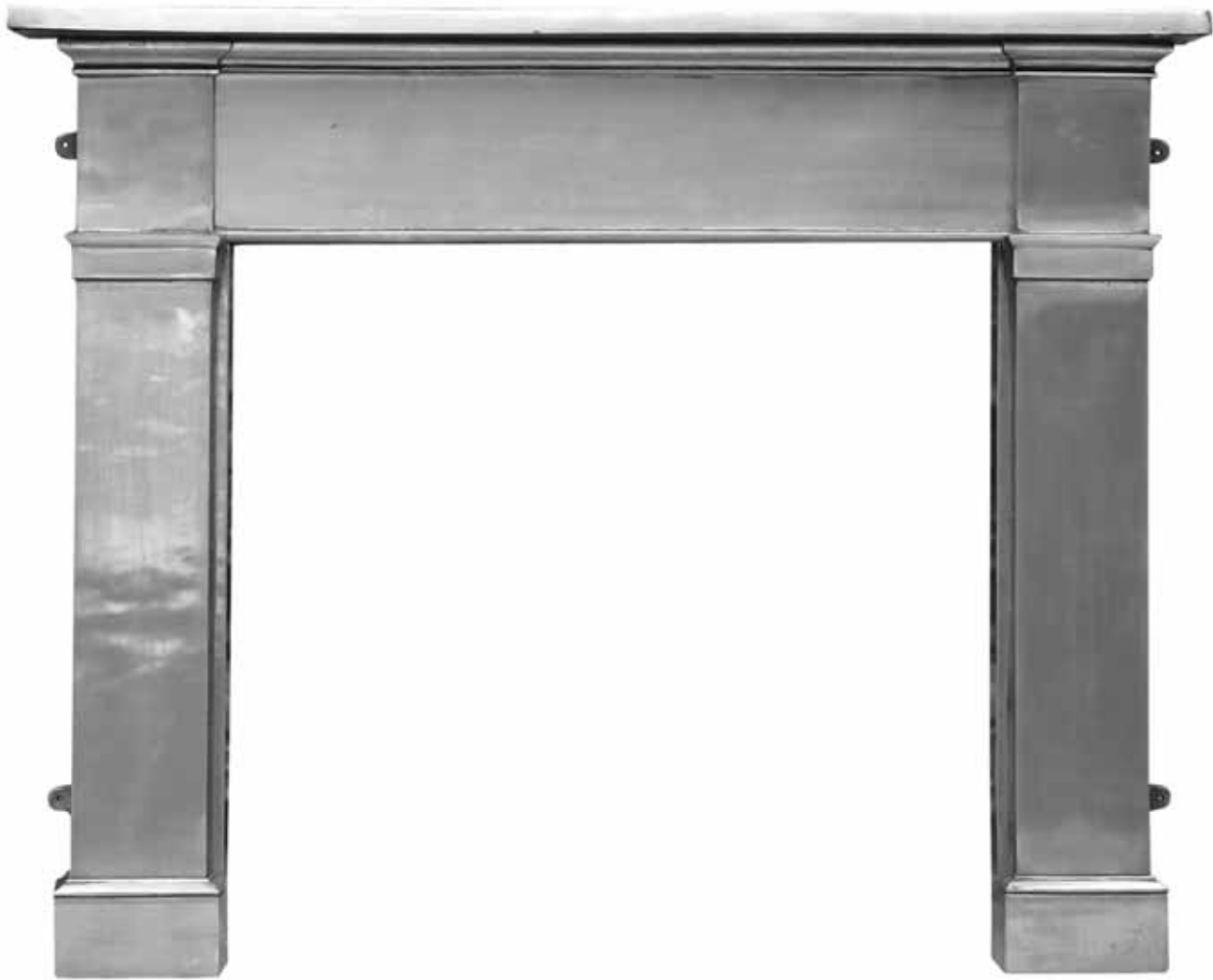

code: RX100 finish: full polish

also available:
code: RX257 finish: black

also available:
code: RX101 finish: black

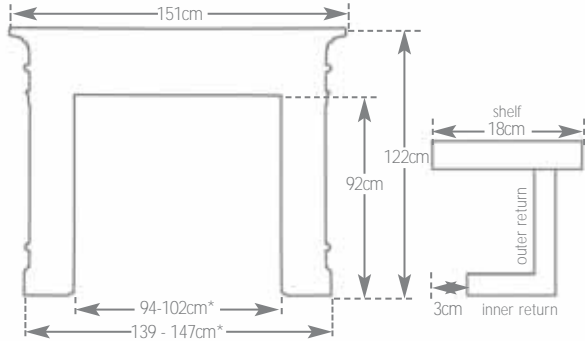
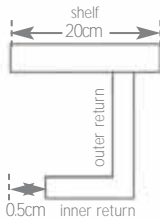
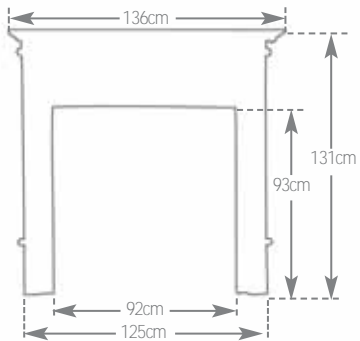

* opening is adjustable

the mayfair surround

the regent surround



code: RX112 finish: full polish



code: RX255 finish: black

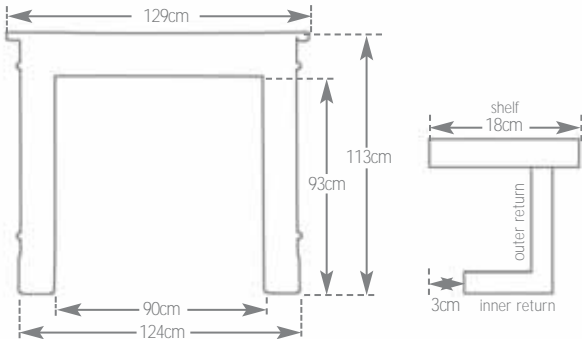
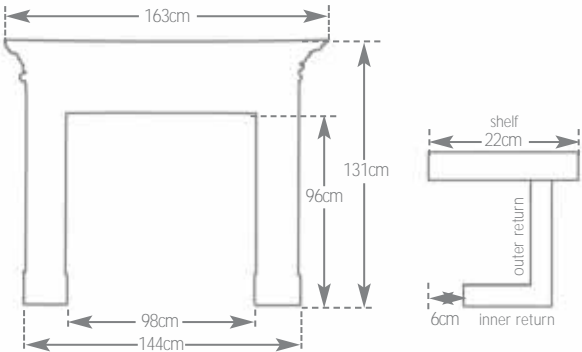

the knightsbridge surround

the albert surround



code: HEB356 finish: black

also available:
code: HEB062 finish: full polish

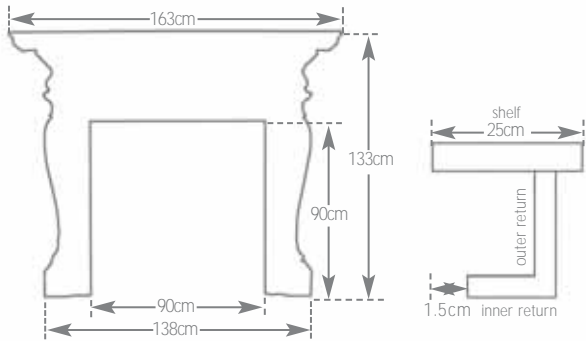

code: RX065 finish: full polish
also available: code: RX121 finish: black

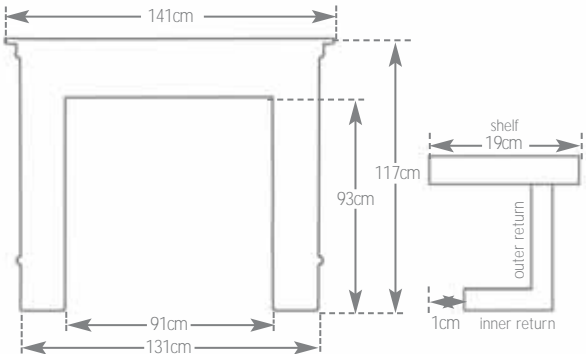

the hampton surround



code: HEF311 finish: black

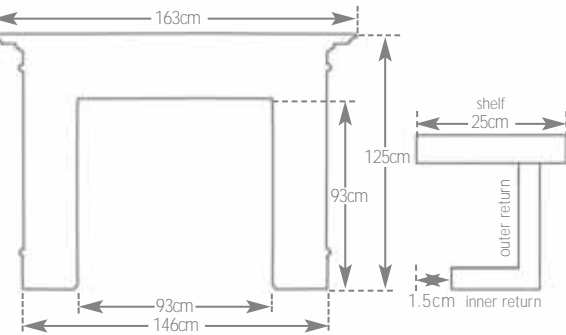

the holyrood surround



code: HEF345 finish: black

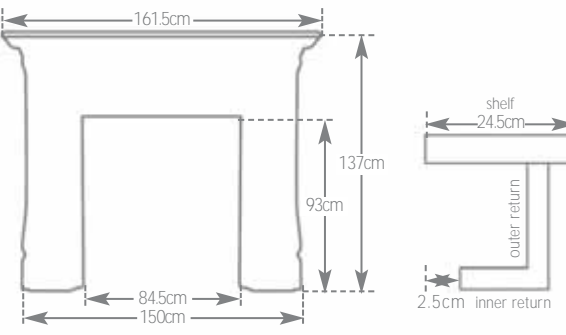

the ashleigh surround

the earlswood surround



code: SMC095 finish: distressed solid oak also available: code: SMC094 finish: unfinished solid oak

code: SMC103 finish: distressed solid oak

also available: the kingsbury surround (with swags on)
code: SMC091
finish: distressed solid oak

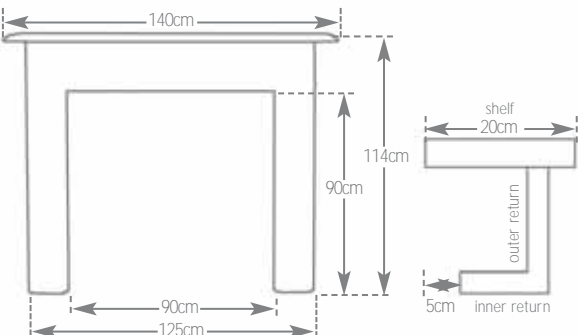
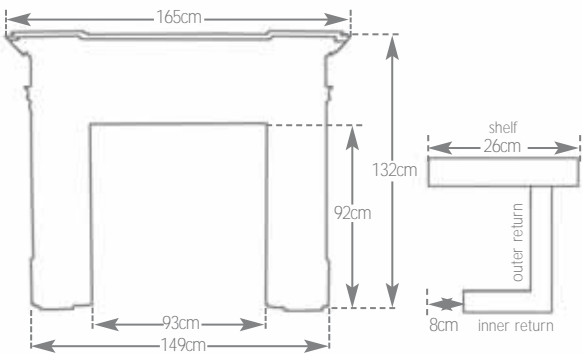

the corbel surround



code: SMC118 finish: waxed solid oak (code: SMC173 finish: unwaxed solid oak)

also available:
code: SMC179 wide opening finish: waxed oak
code: SMC180 wide opening finish: unwaxed oak

also available:
code: SMC007 finish: waxed solid pine
code: SMC014 finish: unwaxed

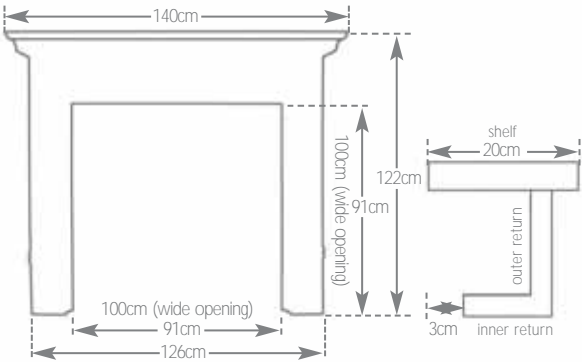

the edinburgh corbel surround



code: SMC116 finish: waxed solid oak also available: code: SMC172 finish: unwaxed solid oak

also available:
code: SMC018 finish: unwaxed solid pine
code: SMC011 finish: waxed solid pine (below)

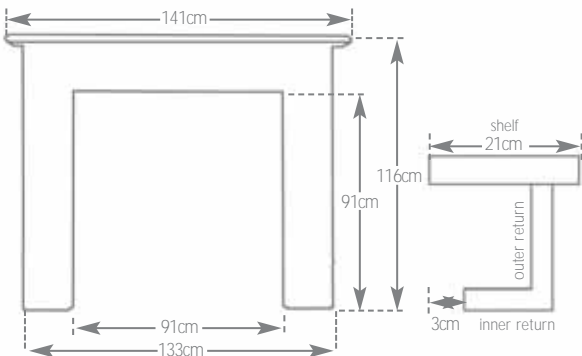

the grand surround

the derry surround



code: SMC117 finish: waxed solid oak



code: SMC119 finish: waxed solid oak

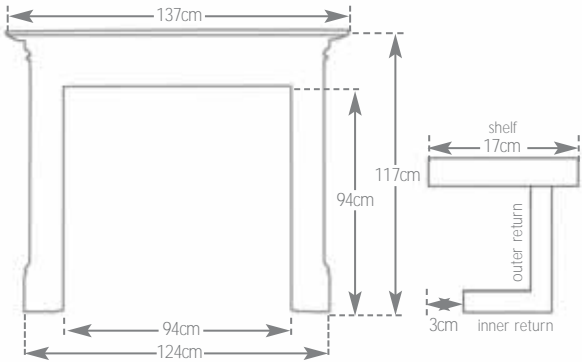

also available:
code: SMC002
finish: waxed solid pine

also available:
code: SMC012
finish: unwaxed solid pine

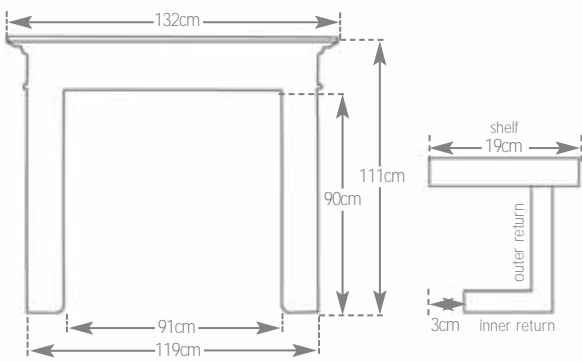

the wessex surround

the wexford surround



code: SMC171 finish: waxed solid oak

code: SMC106 finish: unwaxed pine

also available:
code: SMC177 wide opening finish: waxed oak
code: SMC178 wide opening finish: unwaxed oak

also available:
code: SMC111 finish: unwaxed
code: SMC110 finish: waxed solid pine

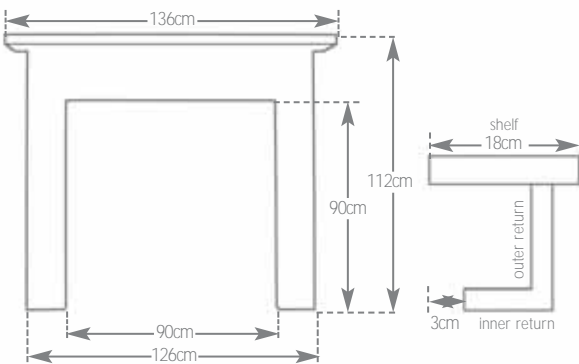
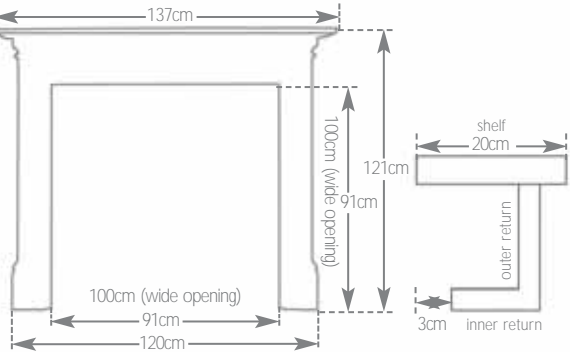



code: TH551 finish: natural solid sheesham

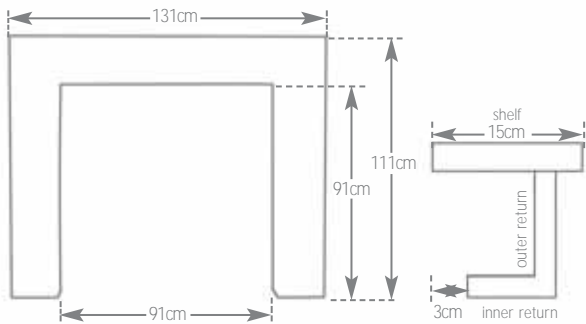

code: TH553 finish: natural solid sheesham

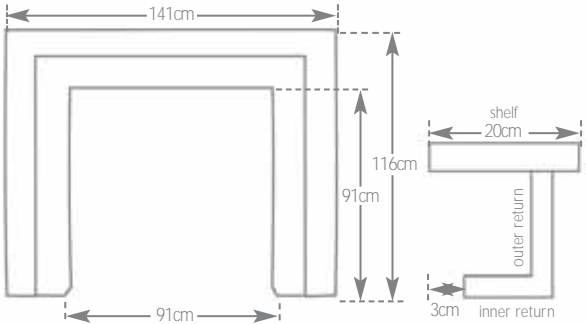

the colorado surround



code: TH552 finish: natural solid sheesham

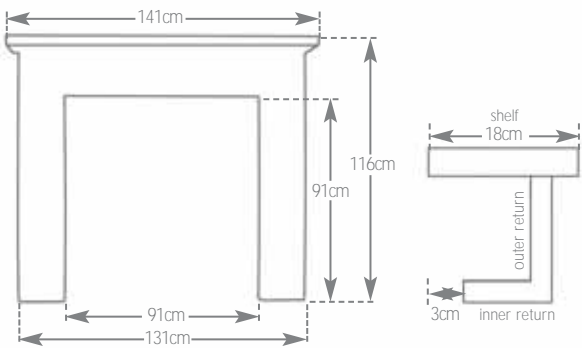

the new hampshire surround



code: TH559 finish: natural solid sheesham

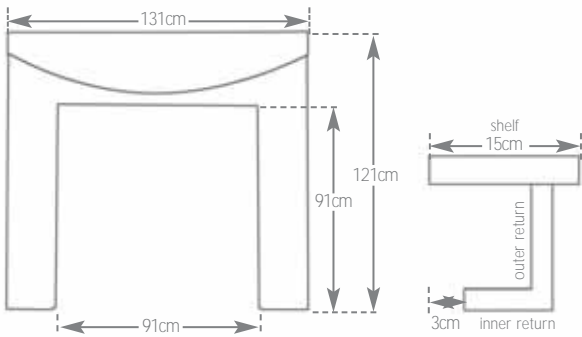



code: SMC151 finish: light oak veneer



code: TH556 finish: natural solid acacia

also available:
code: TH578 finish: dark solid fruit wood
code: MW736 (narrow opening) finish: dark solid fruit wood

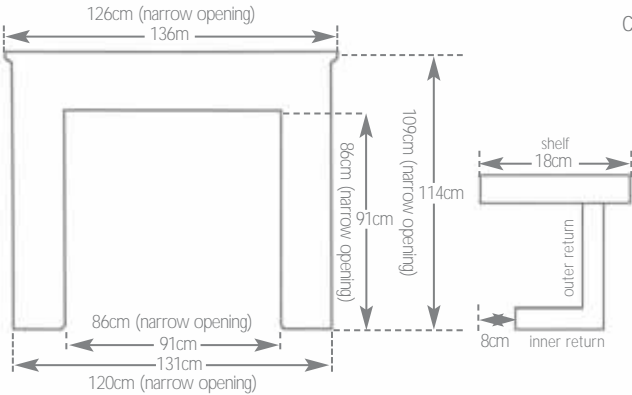

also available:
code: TH558 finish: solid stone sheesham
code: TH577 (narrow opening) finish: solid stone sheesham

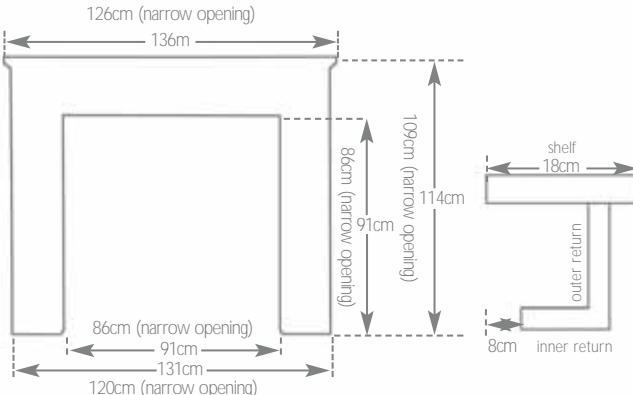

the manhattan surround

the new york surround

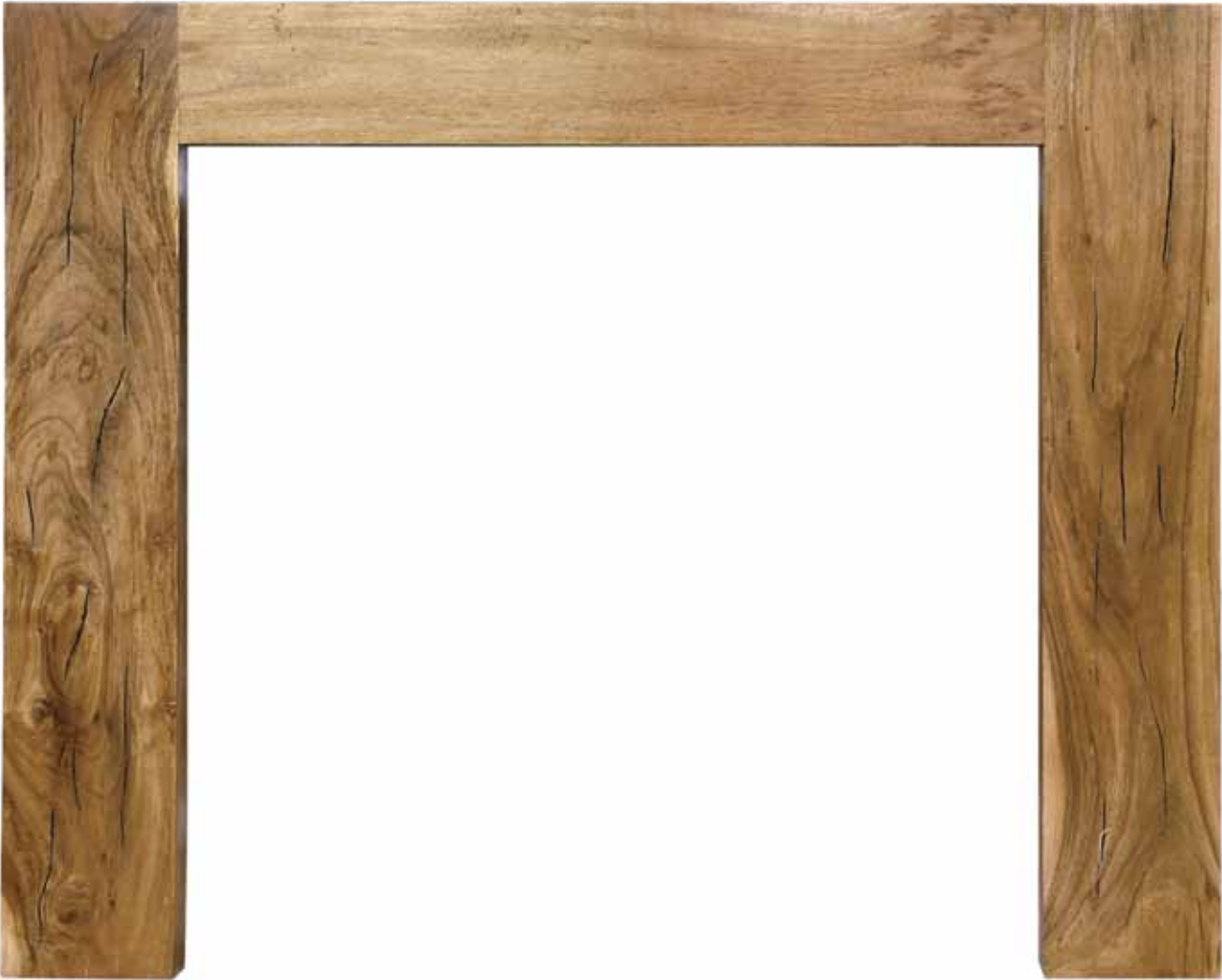

code: TH555 finish: distressed solid acacia



code: TH554 finish: distressed solid acacia

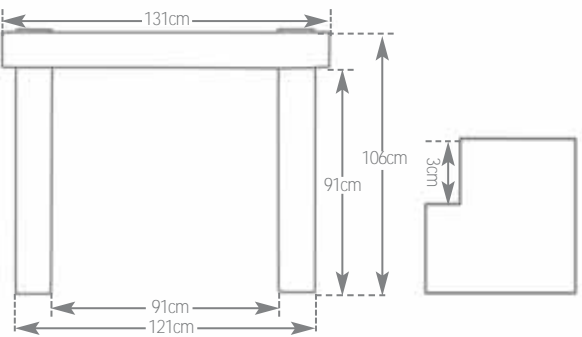
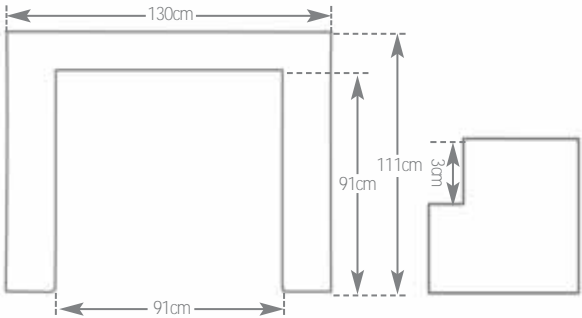

the milan surround

the thakat surround



code: SSU068 finish: stone sheesham



code: TH557 finish: chestnut solid acacia

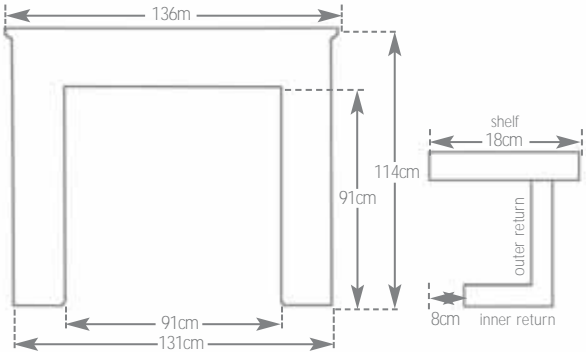
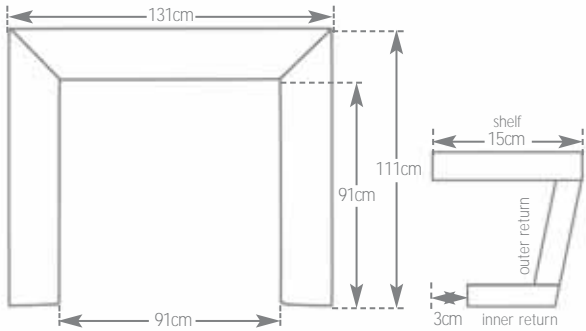



code:
LGC089



code:
LGC003



code:
LGC008



code:
LGC095



code:
LGC092



code:
LGC094



code:
LGC093



code:
LGC091



code:
LGC042



code:
LGC021



code:
LGC088



code:
LGC029



code:
LGC084



code:
LGC090



code:
LGC085



code:
LGC065



code:
LGC067



code:
LGC072



code:
LGC078



code:
LGC079



code:
LGC080



code:
LGC081



code:
LGC059



code:
LGC062



code:
LGC055



code:
LGC056



code:
LGC057



code:
LGC074



code:
LGC075



code:
LGC086



code:
LGC016



code:
LGC018



code:
RX080



code:
RX081



code:
HEB319



code:
HEB319



code:
LGC011



code:
LGC012



code:
LGC013



code:
LGC014



code:
LGC015



code:
LGC083



code:
LGC087

hearth

absolute black granite



1 piece hearths

size (cm)	code
92 x 38	HEF281
107 x 38	HEF282
127 x 38	HEF283
132 x 38	HEF284
137 x 38	HEF285
137 x 46	HEF088
152 x 46	HEF286
Slip Under	HEF299

4 piece hearths

size (cm)	code
127 x 38	HEF288
132 x 38	HEF289
137 x 38	HEF290
137 x 46	HEF087
152 x 46	HEF089
Slip Under	HEF299

tiles

All our tube lined tiles are hand painted. The crazing that appears in the glaze is a natural characteristic for this type of product.